

## MODEL 41 POWER TAKE-OFF FOR ALL WILLYS 4x4 TRUCKS, UTILITY WAGON, AND UTILITY DELIVERY

Included in Model 841RT King Winch Assembly

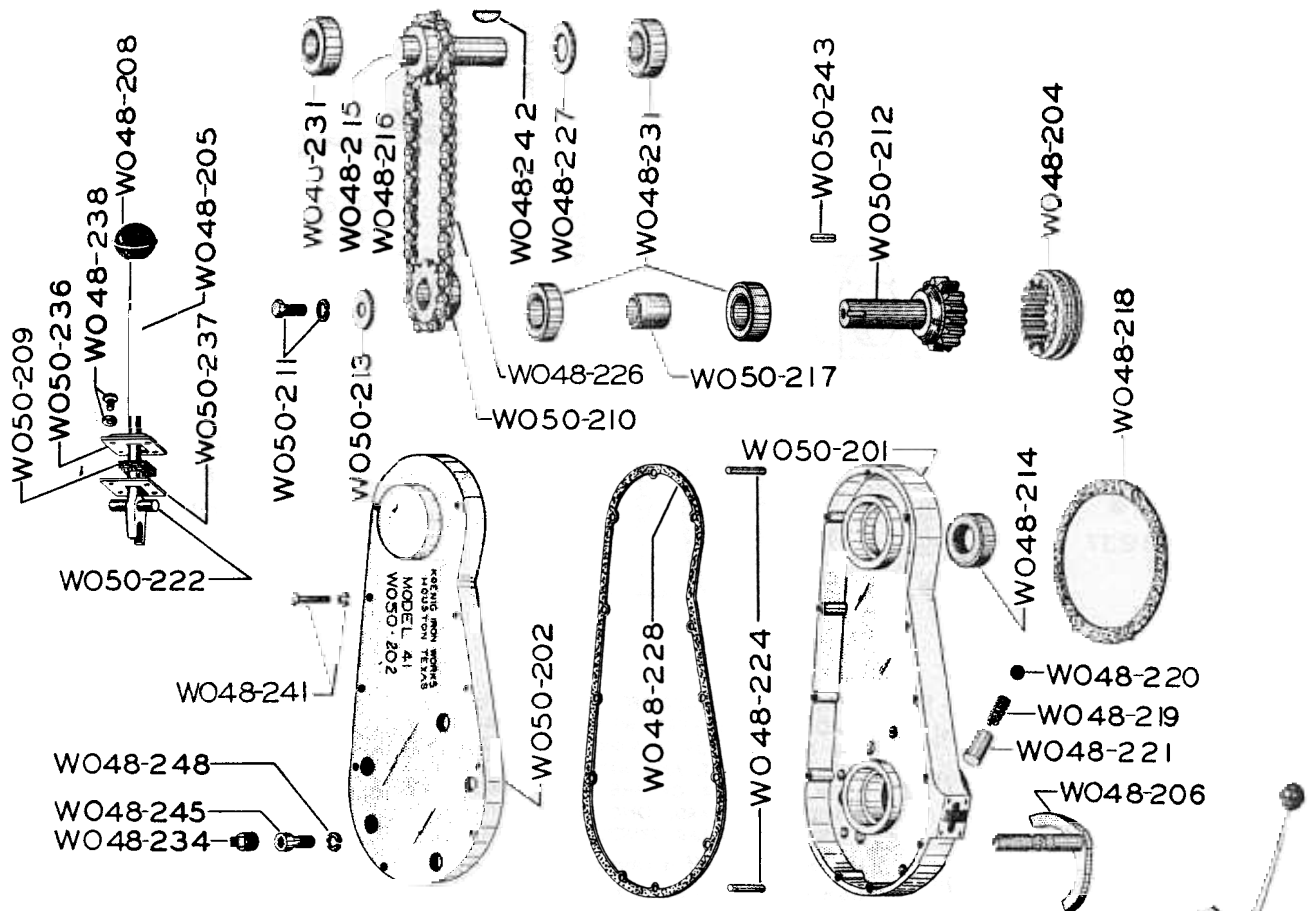

PART No.	DESCRIPTION
WO50-201	Housing—front half
WO50-202	Housing—Rear half
WO50-203	Housing Assembly
WO48-204	Sliding Ring
WO48-205	Lever
WO48-206	Shifter
WO48-208	Knob
WO50-209	Felt Oil Retainer
WO50-210	15 Tooth Sprocket
WO50-211	Retaining Bolt and Washer
WO50-212	Main P.T.O. Shaft
WO50-213	Retaining Washer
WO48-214	Oil Seal
WO48-215	P.T.O. Shaft
WO48-216	16 Tooth Sprocket
WO50-217	Main Shaft Spacer
WO48-218	Gasket—P.T.O. to Transmission
WO48-219	Spring
WO48-220	Ball
WO48-221	Bushing
WO50-222	Pin
WO48-224	Dowel Pin (2 req.)

THIS POWER TAKE-OFF IS FURNISHED WITH MODEL 841RT KING WINCH ASSEMBLY, AND IS SUITABLE FOR DRIVING THE KING WINCH OR OTHER EQUIPMENT ON THE FRONT ONLY OF THE WILLYS TRUCK. HAS THREE SPEEDS FORWARD, ONE SPEED REVERSE (BY USE OF REGULAR TRUCK TRANSMISSION).

PART No.	DESCRIPTION
WO48-226	Roller Chain and Link
WO48-227	P.T.O. Shaft Spacer
WO48-228	Housing Gasket
WO48-231	Ball Bearing (4 req.)
WO48-234	3/8" Pipe Plug (5 req.)
WO50-236	Top Shifter Plate
WO50-237	Bottom Shifter Plate
WO48-238	Shifter Plate Screw (4 req.)
WO48-239	Connecting Link
WO48-240	Set Screw for WO48-216
WO48-241	Cap Screw (10 req.)
WO48-242	Woodruff Key No. 15 (2 req.)
WO50-243	Key for WO50-210
WO48-245	Socket Cap Screw (5 req.)
WO48-248	Lock Washer — Hi-Coller (5 req.)

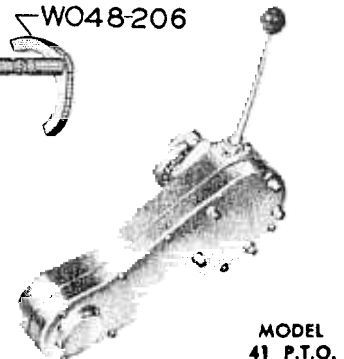

MODEL 41 P.T.O.

This power take-off is lubricated from transfer case by oil...